

Features

- ▶ Microprocessor Controlled
- ▶ Four Configurative Serial Ports
- ▶ Printer Serial Port
- ▶ Firecom ASCII Protocol Port
- ▶ Echelon® LonTalk® Communications
- ▶ Seven Segment Diagnostic LED
- ▶ Low Power Consumption
- ▶ 1/2 Module Footprint
- ▶ All Wiring Power Limited

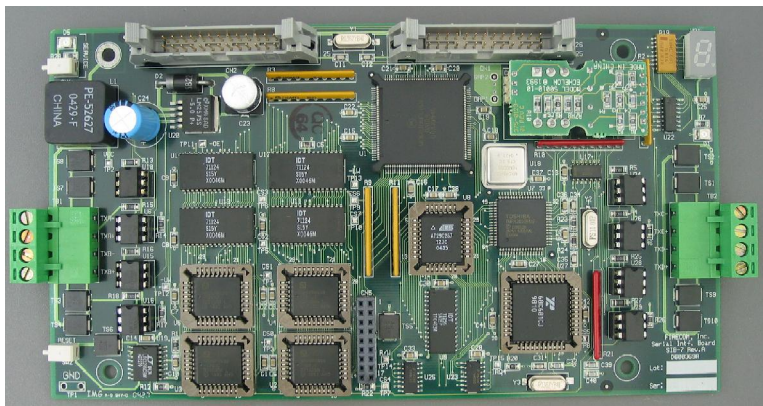

Description

The SIB-7 Serial Interface Board is used to send system events within the Firecom Life Safety Net 2000® (LSN-2000) system to a desktop 80 column printer. The SIB-7 contains four ports that are individually configured in software. Each port can be configured as a Printer or Firecom ASCII Protocol. All ports communicate with devices via 20mA current loop. When the port is configured as a printer, it connects to a desktop 80 column printer that prints all events in black. When the port is configured as Firecom ASCII Protocol, all system events are sent in ASCII text. This text provides a gateway of fire alarm information to other systems.

Application

The SIB-7 is used to send system events to a desktop 80 column printer. The SIB-7 communicates via current loop which allow these peripheral devices to be placed up to 1000 feet away. All wiring to the devices is supervised and power limited. The Firecom ASCII protocol port provides a gateway for information about the fire alarm system to be passed to other systems in the building such as the building automation system. By writing a simple program to receive this alphanumeric string of information, a HVAC system can position its fans and dampers accordingly or know a fire condition has occurred.

Approvals and Listings

Underwriters Laboratories (File No. S2184)
NYC MEA (MEA No. 32-95-E)



Installation

The SIB-7 Serial Interface Board occupies 1/2 module footprint and mounts to the MP-1 Mounting Plate. The SIB-7 can also be mounted behind the BFM-1, BFM-2 or BFM-3 Blank Filler Modules.

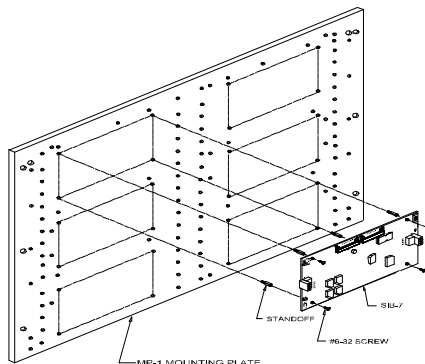

Engineering Specifications

The SIB-7 Serial Interface Board shall provide four independent serial ports. Each port shall be configured in software if used. All ports shall contain a passive 20mA current loop. Single devices connected to any port of the SIB-7 shall be configured as an active 20mA current loop device. The Serial Interface Board shall be capable of communicating with a desktop 80 column printer or transmit system event transactions in Firecom ASCII protocol. All events printed by the printer will be printed black. When the SIB-7 port is configured as Firecom ASCII protocol, it shall transmit an alphanumeric string for each system event. The SIB-7 shall be mounted in the FCC or a remote enclosure. It shall occupy 1/2 module footprint.

Wiring Connection

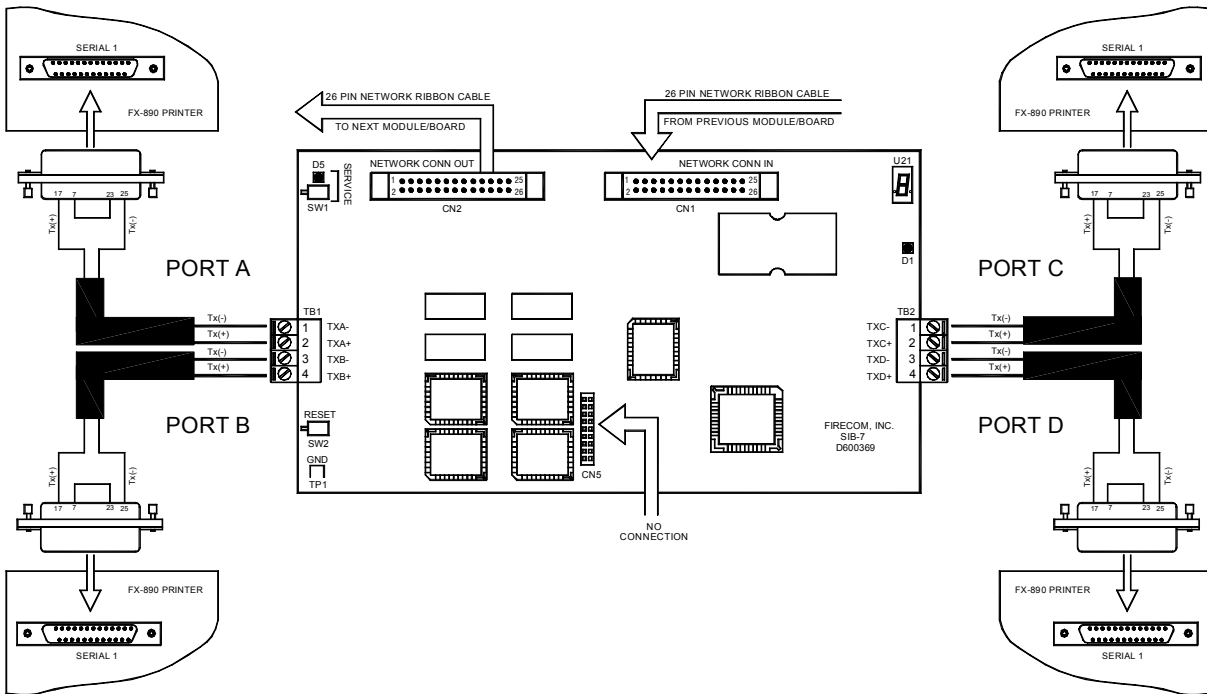

Electrical Specifications

Operating Voltage	24VDC
Operating Current	70mA
Operating Temperature	0°C to 49°C
Operating Relative Humidity Range	0% to 93% @ 32°C

Ordering Information

Model No.	Part No.	Description
SIB-7	71863	Serial Interface Board
FX-890	06400	80 Column Printer

It is our intention to keep the product information up to date and accurate. We cannot cover all specific applications or anticipate all requirements. All specifications are subject to change without notice. For more information contact: FIRECOM, INC.

FIRECOM™, INC.
 39-27 59th Street
 Woodside, NY 11377
 718.899.6100 TEL
 718.899.1932 FAX



FIRECOMINC.COM

71566
 Rev 081021
 2 of 2